

DL-20

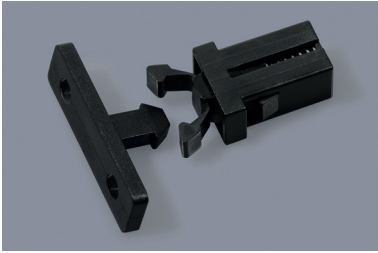

Arretierungen, mit Feder

Spring-loaded door latches and strikers

Material:

Schnappverschluss:

Hülse: POM, ■ schwarz
Klemmhaken: PA, ■ schwarz
Feder: Edelstahl (SUS)
Einsatztemperatur: -10°C bis +60°C

Schließdorne:

ABS UL-94 HB ■ schwarz
Einsatztemperatur: -40°C bis +90°C

Langlebigkeit: mind. 30.000 Zyklen bei Raumtemperatur.

Schnappverschluss Door latches

Art.-Nr.	Artikel-Bez.	Typ	Durchbruch im Chassis	MS _{CH}	Farbe
19902	DL-20-1 POM sw	A	□ 8,0 x 7,0	2,0	■
19903	DL-20-2 POM sw	B	□ 8,0 x 7,0	2,0	■

Unit: mm · MOQ 100x

Typ A

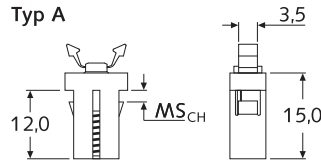

Typ B

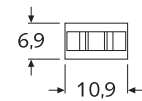
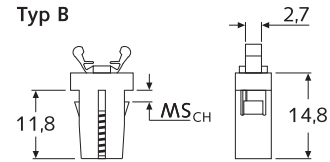

Gegenstück Counter Part

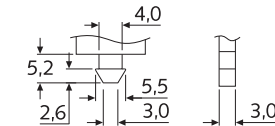

Montagebohrung Mounting Hole

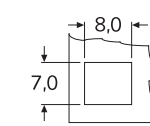

Geschlossen Locked Position

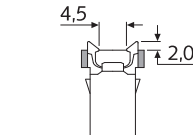

Passende Schließdorne Matching strikers

Art.-Nr.	Artikel-Bez.	Farbe
19904	DL-20-D1 ABS sw	■

Unit: mm · MOQ 100x

Art.-Nr.	Artikel-Bez.	MS _{LP}	Farbe
28709	DL-20-D2 ABS sw	0,7-2,0	■

Unit: mm · MOQ 100x

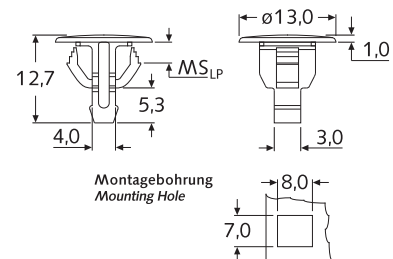
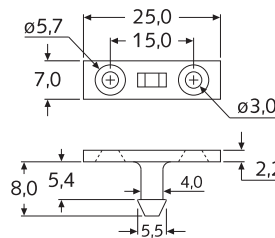

Montagebohrung Mounting Hole

DL-20



Arretierungen, mit Feder

Spring-loaded door latches

Material:

Schnappverschluss:

Hülse: POM, ■ schwarz
Klemmhaken: PA, ■ schwarz
Feder: Edelstahl (SUS)
Einsatztemperatur: -10°C bis +60°C

Langlebigkeit: mind. 30.000 Zyklen bei Raumtemperatur.

Schnappverschluss Door latches

Art.-Nr.	Artikel-Bez.	Durchbruch im Chassis	MS _{LP}	MS _{CH}	Farbe
31413	DL-20-3 POM sw	□ 6,5 x 4,4	max	2,0	■

Unit: mm · MOQ 100x

Geöffnet Open

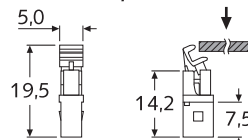

Geschlossen Closed

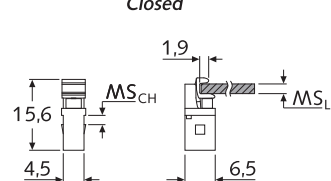

Montagebohrung Mounting Hole

